

## Maintenance

**In the event of heater failure please contact Schaefer Ventilation.**

- Disconnect the power before starting any maintenance procedure including cleaning.
- TO ENSURE OPTIMUM EMITTER LIFE EXPECTANCY AND HEAT EFFECTIVENESS as soon as white residue appears on the glass cover, the reflector or the emitter, open the cover and wipe the front glass, reflector and emitter with a lint-free cloth before resealing. *Do not touch the emitter with bare hands!*

**Failure to maintain the heater by cleaning white residue WILL reduce the life of the emitter and WILL decrease performance of the unit. Emitter failure due to lack of maintenance WILL NOT BE COVERED UNDER WARRANTY.**

- The heater is supplied with toughened safety glass. In the unlikely event that this should become cracked, contact Schaefer Ventilation for a replacement.

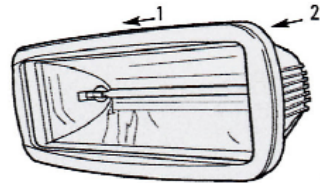
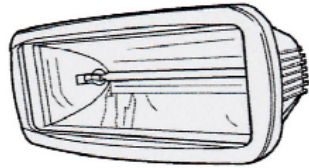

Fig. 1

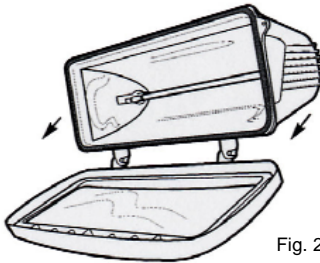

Fig. 2

## Replacing the emitter

1. Disconnect the power supply and ensure that the heater body and emitter are cool.
2. Unscrew the back two screws at top of the casing using a 3mm Allen key. See Fig. 1.
3. Open hinged front cover. See Fig. 2.
4. Remove the emitter from spring-loaded holders by pushing one end further into its holder and pulling the end that is now free towards you as shown in Fig. 3.
5. Refit in reverse order.

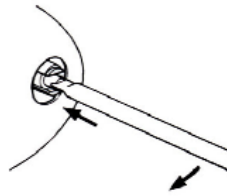
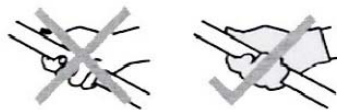

Fig. 3

**CAUTION: Do not handle the emitter with bare hands. Remove finger marks with a soft cloth and methylated spirits or alcohol. Finger marks will burn into quartz causing premature emitter failure.**



## WARRANTY

Schaefer Ventilation Algarve Quartz Heating Products carry a full 12 month warranty from date of purchase on all components, with the exception of a 180 day limited warranty on the emitter when used in accordance with manufacturers instructions. This is subject to the product being installed and maintained correctly. Should you have any questions, please call our CUSTOMER SERVICE helpline at 1-800-779-3267, Monday - Friday, 8:00 am - 4:30 pm CST.

In accordance with Tansun's policy of continuous development.  
We reserve the right to modify designs, specifications, and prices without prior notice.  
©2008 Schaefer Ventilation Equipment 1-7-08

ALGARVE  
QUARTZHEAT

# Reference Manual

Models T-ALG-212 and T-ALG-220



  
**SCHAEFER**  
Ventilation Equipment  
*"Quality and Innovation since 1951"*

www.patiocomforts.com • 1-877-264-3794

The Algarve patio heater produces heat like the sun, warming people and objects and not the air in between, providing the only form of heat that will not blow away. The Algarve is primarily designed for outdoor use and it is therefore weatherproof (IP54 rated) and UL Listed.

**Please read the following instructions carefully before use. The safety of this heater is guaranteed only by its correct usage in accordance with these instructions, therefore it is recommended that they are retained for future reference.**

**\*\* Caution! \*\* Before using this appliance:**

- Check that the voltage indicated on the data plate corresponds to the main supply voltage.
- Ensure that the heater has been securely fastened to the mounting.
- Disconnect main power during installation, cleaning and/or emitter replacement and ensure that the emitter is cool.
- **Do not handle the halogen emitter with bare hands. If it is advertently touched, remove finger marks with a soft cloth and methylated spirits or alcohol. Finger marks will burn into the quartz, causing premature heater failure.**
- Touch the front glass as little as possible in order to avoid grease residue.
- Do not use an extension cord with this product.
- Keep the main cable away from the body of the heater which will get hot during use.
- Do not cover or obstruct the heater when in use.
- Ensure that no one tampers with the heater.
- Do not insert any object into the heater.
- Do not use if glass is broken.



**Risk of Fire**

Keep combustible materials such as furniture, papers, clothes and curtains **at least 6 feet** from the front of the heater and away from the sides and back. If the heater is to be used outside, a weatherproof outlet is recommended.

Specifications	T-ALG-212	T-ALG-220
Voltage (V)	120	220
Total power (W)	1200	1200
Amps (A)	10	5
Minimum height from floor	8'2"	
Minimum distance from ceiling	1'7 5/8"	
Minimum distance from side wall	4'11"	
Dimensions W x H x D	15 3/4" x 7" x 5 3/4"	
Weight	4.5 lb.	
Insulation class	1	
Lamp holder	R7S	
Ingress protection	IP54	

**Table 1**

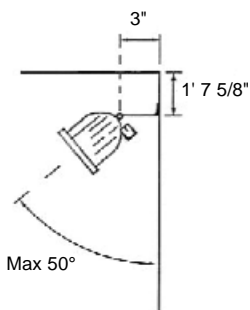
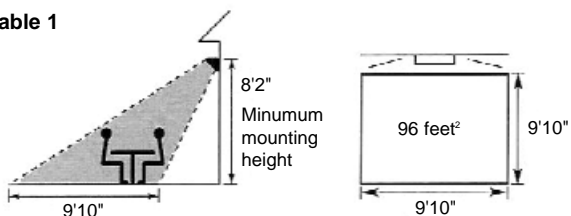

**Installation Instructions**

**Wiring**

**\*\* Warning \*\*** *This heater must be grounded.*

- The 120V model is fitted with a 16' power cord with a molded plug.
- The 220V model is fitted with a 16' power cord but DOES NOT INCLUDE A PLUG. A suitable plug must be installed or the unit must be hardwired by a qualified electrician.
- It is unnecessary to remove the terminal box cover in order to carry out normal installation of these models.
- All installations must be in accordance with the I.E.E. safety regulations or equivalent.
- When the electrical connection is outside, it is recommended that a waterproof socket is used for the connection/termination.
- If in any doubt, please contact a suitably qualified electrician.

**Mounting**

- Please refer to Table 1 for the recommended positioning of the heater.
  - The heater **MUST** be mounted horizontally (parallel to the floor). **DO NOT** hang from ceiling.
  - Observe the minimum safe distance between the heater body and flammable surfaces when mounting.
  - The heater **MUST** be installed on the mounting bracket provided.
1. Fasten the bracket securely to the mounting surface using the fixing holes in the mounting bracket.
  2. Fasten the heater securely on the bracket using the nut and bolt supplied. See Fig. 1 and Fig. 2.
- Allow the heater to cool before attempting to reposition/ move. Never attempt to move the heater with it switched on!

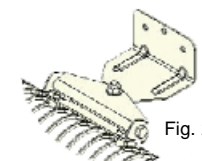
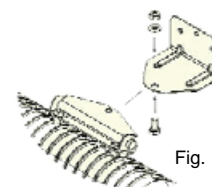

\*All measurements are approximate and can be subject to change without prior notification.